

www.invarion.com



8319 Young Road, Chilliwack
JOB # 31116376

HOURS OF OPERATION:
9:00AM - 5:00PM

3:00PM



Traffic Management Plan Designed By
Condon Utility Construction
Jordan Nestor 604-828-0244

NOTE:
ALL SIGNS WILL BE PLACED ON TRIPOD STANDS WITH FLAGS
TRAFFIC CONTROL WILL ASSIST WITH OREWEAYS EFFECTED BY WORK ZONE CLOSURE
ALL SIDEWALKS - CROSSWALKS WILL REMAIN OPEN
TWO DIRECTIONS OF TRAFFIC WILL BE MAINTAINED

LEGEND	
Traffic Flow	→
Tubular Markers	*****
Work Area	□□□□
Sign Stands	■
Traffic Controller	⚠
Bus Stop	Ⓚ
Power Pole	⚡
No Parking Area	→

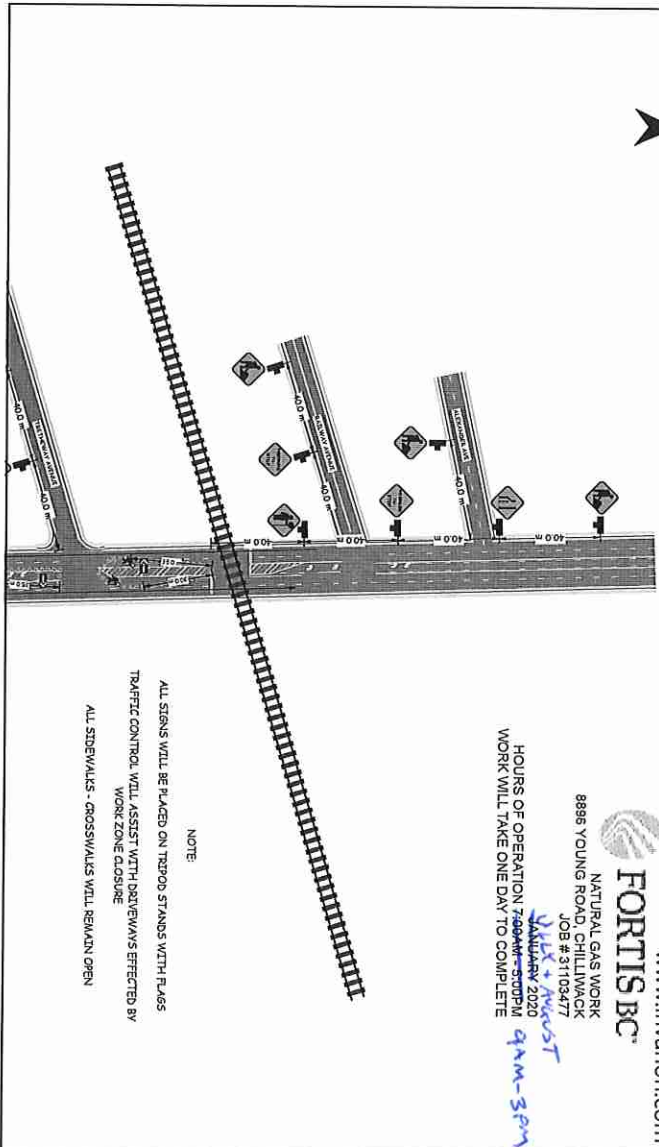

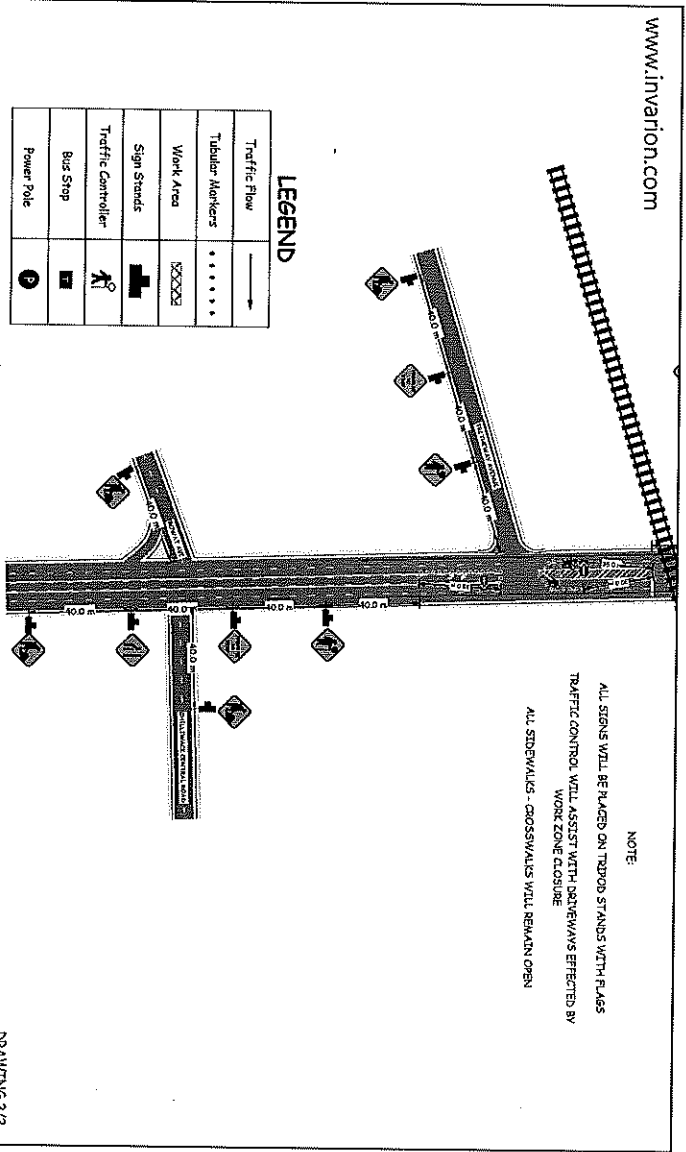

LEGEND

Traffic Flow	→
Tubular Markers
Work Area	XXXXX
Sign Stands	■
Traffic Controller	Ⓜ
Bus Stop	■
Power Pole	Ⓜ

NOTE:
ALL SIGNS WILL BE PLACED ON TRIPDS STANDS WITH FLAGS
TRAFFIC CONTROL WILL ASSIST WITH BARRIERS EFFECTED BY
WORK ZONE CLOSURE
ALL SIDEWALKS - CROSSWALKS WILL REMAIN OPEN